

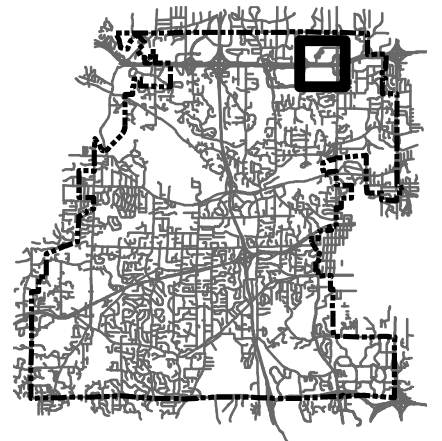

LOCATION MAP

Project: Inland Development Concept
Location: 11800 Wayzata Blvd





FENCED IN PET EXERCISE AREA WITH PET VIEWING PATIO

EXISTING TRASH ENCLOSURE (SHOWN DASHED)

PET FRIENDLY WALKING TRAIL

MARSH RUN II

EXISTING 1.5 STORY OFFICE BUILDING

FAIRFIELD RD

FAIRFIELD WAY

FAIRFIELD CT

FAIRFIELD CT

FAIRFIELD WAY

Minnetonka

BIRKE PEDESTRIAN EXIT

THE BIRKE

BIRKE PEDESTRIAN EXIT

STAPLES

WAYZATA BLVD

INTERSTATE 394



SCALE: 1" = 100'



FENCED IN PET EXERCISE AREA WITH PET VIEWING PATIO

PET FRIENDLY WALKING TRAIL

SHORT TERM DELIVERY STALLS

TRASH ENCLOSURE

VISITOR PARKING SURFACE STALLS 12 TOTAL

PEDESTRIAN CONNECTION TO WALKING TRAIL

MARSH RUN II

EDGE OF EXISTING BUILDING TO DEMO

ALL GARAGE DOORS ACCESSED FROM INTERNAL DRIVE

TRASH ENCLOSURE (SHOWN DASHED)

MAILBOXES

SITE ENTRY

THROUGH BLOCK PEDESTRIAN CONNECTION TO WALKING TRAIL AND PET PARK (IN YELLOW)

BIRKE ENTRANCE LOBBY

PROPOSED 26 THREE STORY TOWNHOMES @ 36' IN HEIGHT

EXISTING THREE STORY TOWNHOMES @ 36' IN HEIGHT

FAIRFIELD WAY

FAIRFIELD CT

FAIRFIELD CT

FAIRFIELD WAY

THE BIRKE

STAPLES

WAYZATA BLVD

INTERSTATE 394



SCALE: 1" = 100'







EXISTING WOODLAND BUFFER TO REMAIN

PROPOSED THREE STORY TOWNHOMES @ 36' IN HEIGHT

EXISTING THREE STORY TOWNHOMES @ 36' IN HEIGHT

MARSH RUN II

FAIRFIELD RD

WAYZATA BLVD

THE BIRKE



WAYZATA BLVD

MARSH RUN II

EXISTING WOODLAND BUFFER TO REMAIN

PROPOSED THREE STORY TOWNHOMES @ 36' IN HEIGHT

EXISTING THREE STORY TOWNHOMES @ 36' IN HEIGHT

FAIRFIELD RD

EXISTING WOODLAND BUFFER TO REMAIN

THE BIRKE



FAIRFIELD RD

THE BIRKE

WAYZATA BLVD



MARSH RUN II BEYOND

TRASH ENCLOSURE

EXISTING WOODLAND BUFFER TO REMAIN

FAIRFEILD RD

SHORT TERM DELIVERY STALLS

ALIGN DRIVE AISLES

SITE ENTRY

MAILBOXES

THROUGH BLOCK PEDESTRIAN CONNECTION TO WALKING TRAIL AND PET PARK

THE BIRKE DROP OFF AND SHORT TERM PARKING



TOWNHOMES @ 36' IN HEIGHT

PROPOSED THREE STORY TOWNHOMES @ 36' IN HEIGHT

EXISTING WOODLAND BUFFER TO REMAIN

FAIRFEILD RD

THE BIRKE



FRONT EXTERIOR ELEVATION
SCALE: 3/32" = 1'-0"

DOWNSPOUTS PIPED TO STORM

CAST STONE
PANEL

LAP MIX
(2) CUSTOM COLORS
SIM TO RATIO

WHITE PANEL
BLACK PANEL

AMCON ONYX
BURNISHED
BLOCK



BACK EXTERIOR ELEVATION
SCALE: 3/32" = 1'-0"

DOWNSPOUTS PIPED TO STORM

LAP MIX
(2) CUSTOM COLORS
SIM TO RATIO

5.25" TRIM

DOOR SILL 9"
DOWN FROM LEVEL 1

AMCON ONYX
BURNISHED
BLOCK



SIDE EXTERIOR ELEVATION
SCALE: 3/32" = 1'-0"

9 AM

12 PM

3 PM

6 PM

MAR / SEPT 21ST



JUNE 21ST



DEC 21ST

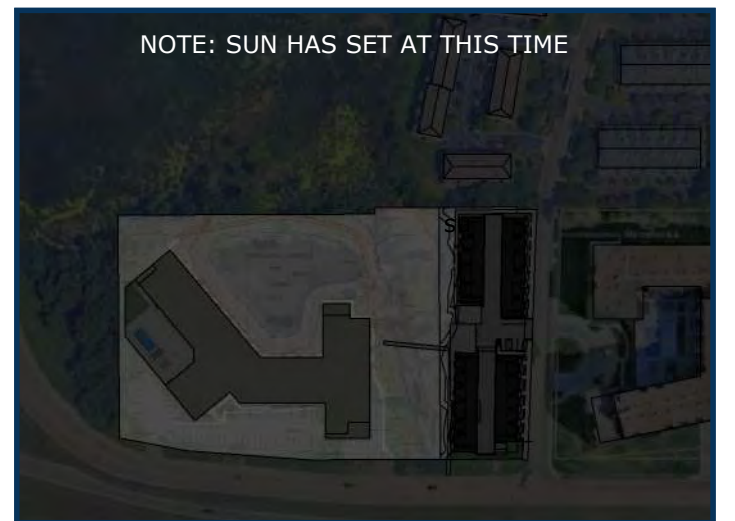

NOTE: SUN HAS SET AT THIS TIME



SCALE: 1" = 300'

MARSH RUN II APARTMENTS

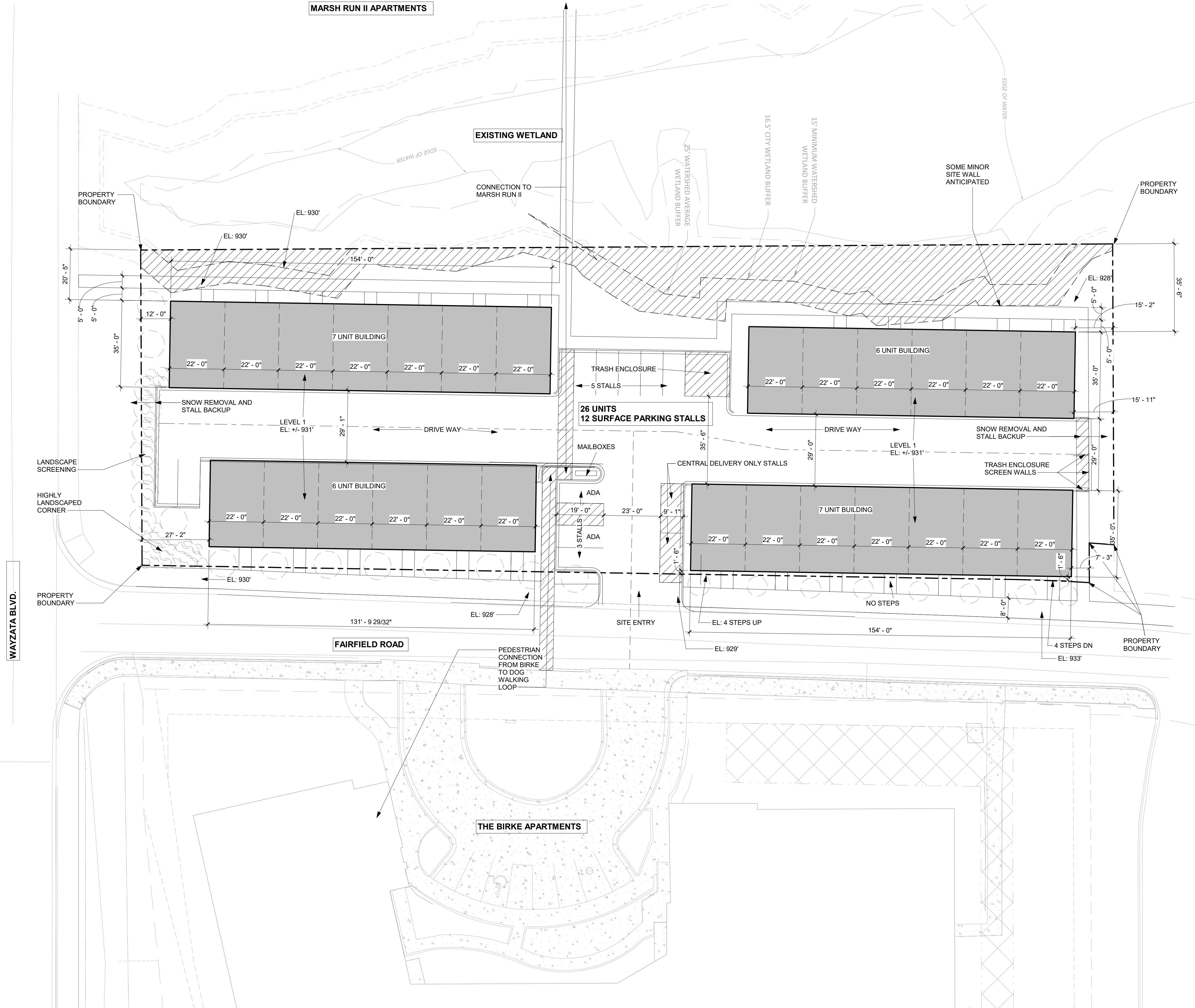

ARCHITECT:

DORAN
ARCHITECTURE

7803 Glenroy Road, Suite 200
Bloomington, MN 55439
952-288-2000
952-288-2031 fax

ISSUE RECORD

No.	Description	Date

NOT FOR CONSTRUCTION

PROJECT
MARSH RUN III

LOCATION
Minnetonka, MN. 55305

PROJECT NUMBER

DATE
06/20/24

PROJECT MANAGER

DRAWN BY

CHECKED BY

PREPARED FOR

DORAN
SPECIAL PROJECTS

7803 Glenroy Road, Suite 200
Bloomington, MN 55439
952-288-2000
952-288-2031 fax

SHEET TITLE

DETAILED SITE PLAN

SHEET NUMBER

A1-0

