



14600 MINNETONKA BLVD.
MINNETONKA, MN 55345
(952) 939-8200
FAX (952) 939-8244

Residential Fee: \$23.00
Commercial Fee: \$30.00
Date: _____

DRIVEWAY ENTRANCE PERMIT

APPLICANT _____	TYPE OF DRIVEWAY:
ADDRESS _____	<input type="checkbox"/> BUSINESS <input type="checkbox"/> RESIDENTIAL
TELEPHONE _____	PROPOSED DRIVEWAY WIDTH _____
LOT _____ BLOCK _____	CONTRACTOR _____
SUBDIVISION OR P.I.D. _____	ADDRESS _____
PARCEL NO. _____ SECTION _____	TELEPHONE NO. _____

SKETCH OF DRIVEWAY WITH DIMENSIONS (*SHOW DRAINAGE USING ARROWS*):

APPLICANT AGREES TO INDEMNIFY AND HOLD HARMLESS, THE CITY AND ITS EMPLOYEES FROM AND AGAINST ALL CLAIMS, DAMAGES, LOSSES AND EXPENSES, INCLUDING ATTORNEY'S FEES, ARISING OUT OF THE CONSTRUCTION OF THE DRIVEWAY ENTRANCE, IF THE CLAIM, DAMAGE, LOSS, OR EXPENSE:

- A. IS ATTRIBUTABLE TO BODILY INJURY, SICKNESS, DISEASE OR DEATH, OR TO INJURY TO, OR DESTRUCTION OF TANGIBLE PROPERTY, INCLUDING THE LOSS OF USE RESULTING THEREFROM; AND
- B. IS CAUSED IN WHOLE OR IN PART BY ANY NEGLIGENT ACT OR OMISSION OF APPLICANT OR THE APPLICANT'S CONTRACTORS, EMPLOYEES, OR AGENTS.

 (Do not write below this line) DATE SIGNATURE OF APPLICANT

SPECIAL PROVISIONS:

TURNAROUND REQUIRED: YES NO

DRAINAGE REQUIRED: _____

COMMENTS: _____

(NOTE REQUIREMENTS ON REVERSE SIDE) APPROVED BY _____
 DATE _____
 INSPECTED BY _____
 DATE _____

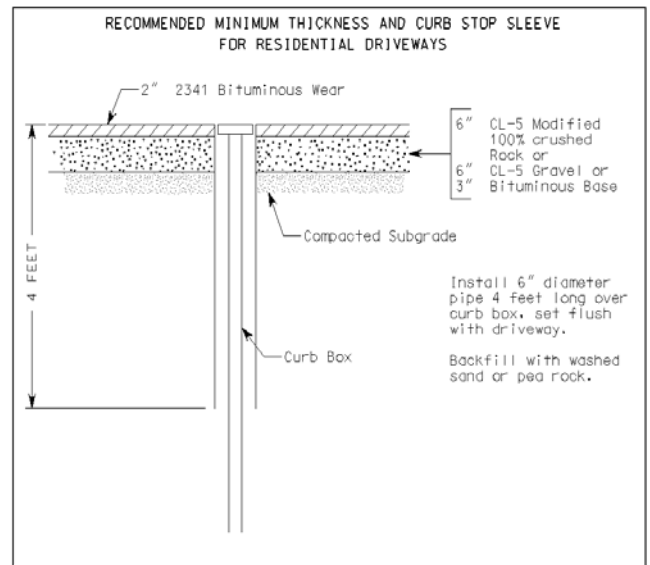
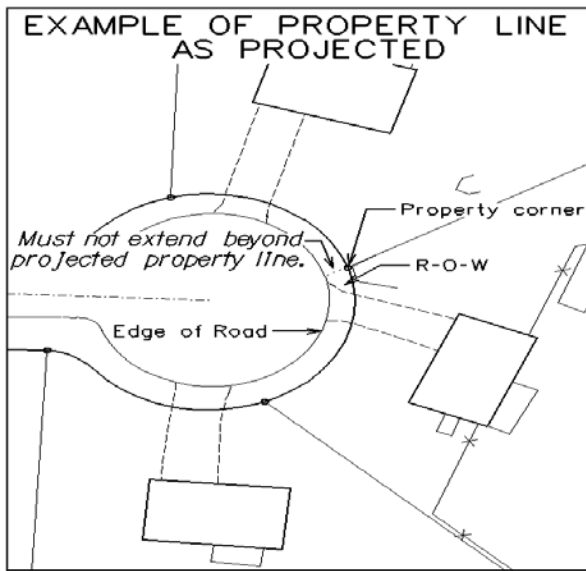

GENERAL REQUIREMENTS

- A person must not construct, alter, or extend, or permit or cause to be constructed, altered or extended a driveway approach that can be used only as a parking space.
- A driveway approach must intersect the street pavement at an angle to be approved by the city engineer based upon the physical characteristics of the street and the lot being accessed. The angle should be as close as reasonably practical, in the judgment of the city engineer, to a right angle to the tangent of the curve of the street pavement.
- A curb return must not extend beyond any property line as projected, except when consented to in writing by the adjoining property owner. See detail above.
- The top of the driveway approach paving at the curb line must be 1 inch above the flow line of the gutter, must not extend into the gutter beyond the face of the curb or beyond the gutter line, and must not interfere with the use of the street for the purpose of travel or maintenance. The constructed street must not be excavated unless the city engineer has given written permission.
- Driveway culverts must be provided and installed as required by the city engineer.
- Driveways must not be constructed over curb stops, if at all possible. If there is no other feasible location for the driveway, the curb stop must be set flush with the final driveway surface, and provided with a sleeve, as shown on the typical section attached to the permit.
- The property owner and contractor must protect the public from injury or damage during the construction of the driveway approach. A permit issued under this ordinance must contain the applicant's agreement that the city will not be liable for damage that may arise from the work, and that the applicant will hold the city harmless for any liability incurred by the city as a result of the work performed under the permit.
- Trees or shrubs must not be placed adjacent to the driveway so as to unreasonably interfere with the ability to see traffic on the public street.
- If a lot has frontage on both the turnaround portion of a cul-de-sac and the portion leading to the turnaround, the driveway must be connected to the "lead-in" portion of the street and not the turnaround.
- A driveway approach must provide access to a parking area, a driveway, a door intended and used for the entrance of vehicles, or other similar facility.
- Only one driveway approach will be allowed from a single residential lot to the same street, except that two driveway approaches to the same street may be allowed when the lot frontage on that street is at least 110 feet. Lots having frontage on more than one street will be allowed driveway approaches to each street consistent with the standards in this ordinance.
- A residential driveway approach must not exceed 20 feet in width at the point it intersects with the right-of-way line, except that a driveway approach that provides access to a three-car garage may have a width no greater than 30 feet at that point.
- The total width of driveway approaches to a single lot from a single street must not exceed 35 feet.
- No portion of a driveway approach, except the curb return, may be constructed within 45 feet of a corner.